

Gen2 Passive Interposer for PCI Express® 2.0

Passive Interposer Allows
Reliable Probing of
PCI Express Traffic with
Quick, Simple Setup!

Specifications

| | |
|-------------------|--------------------------------------|
| Dimensions | 146 x 167 mm (5.75" x 6.6") |
| Lane Width | x1, x4, x8 or x16 |
| Data Rates | 2.5 GT/s (Gen1) and 5 GT/s (Gen2) |

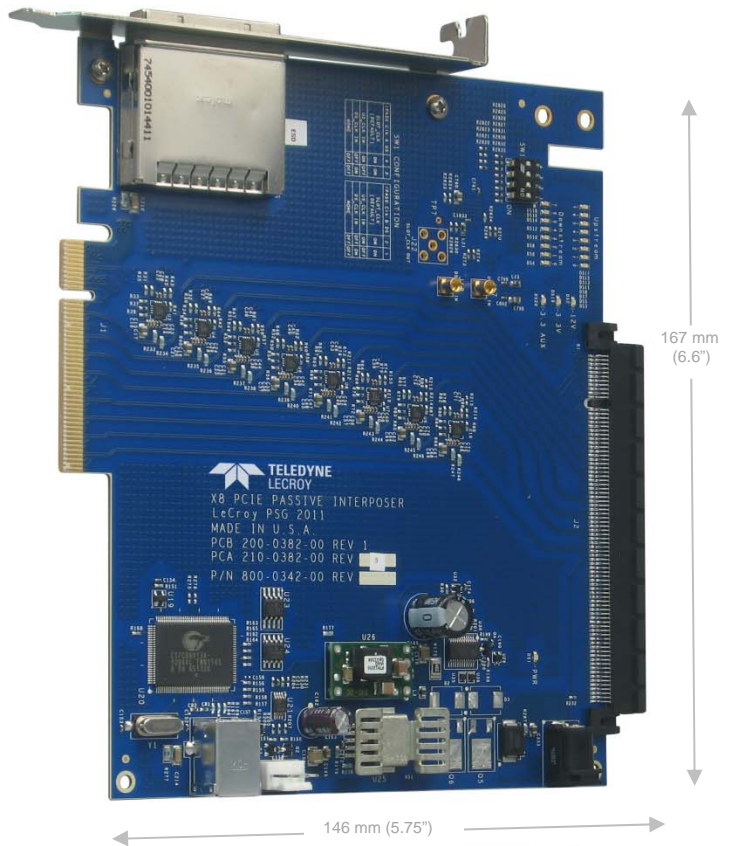

The Teledyne LeCroy Gen2 Passive Interposer provides an economical means to probe PCI Express traffic between a host and PCIe® expansion card. The interposer assures reliable data transmission while providing 100% capture of all data traffic flowing through the PCIe slot interface. Connecting the interposer to a Teledyne LeCroy analyzer allows decoding and display of data flowing in both directions and across all lanes, and will display data traffic using the industry-standard CATC Trace™ data display, along with a wide range of traffic and error reports.

The Gen2 Passive Interposer supports data rates of 2.5 GT/s (Gen1) and 5.0 GT/s (Gen2), and lane widths up to x16.

The Gen2 Passive Interposer is a powerful and versatile tool for all developers working with Gen2 PCIe expansion cards.

Ordering Information

Product Description

| | |
|--|-------------------|
| Passive G2x16 Interposer Card – no cables (for use with Summit T3-16 or two Summit T3-8 systems) | PE075UIA-X |
| Passive G2x8 Interposer Card – no cables (for use with Summit T28, Summit T3-8 or Summit T3-16) | PE074UIA-X |
| Passive G2x4 Interposer Card – no cables (for use with Summit T24, Summit T28, Summit T3-8 or Summit T3-16) | PE073UIA-X |
| Passive G2x1 Interposer Card – no cables (for use with Summit T24, Summit T28, Summit T3-8 or Summit T3-16) | PE072UIA-X |

Note: When using the G2x4 or G2x1 products with the Summit T24 or T34 Analyzer, use the PE013UCA-X iPass x4-to-x8 Straight Cable to connect to the analyzer. With all other systems, use the PE010UCA-X iPass Y-Cable. The G2x16 version requires two Y-Cables for x16 configurations.

Product Code

PE075UIA-X
PE074UIA-X
PE073UIA-X
PE072UIA-X

Gen2 Passive Interposer Interconnection Overview

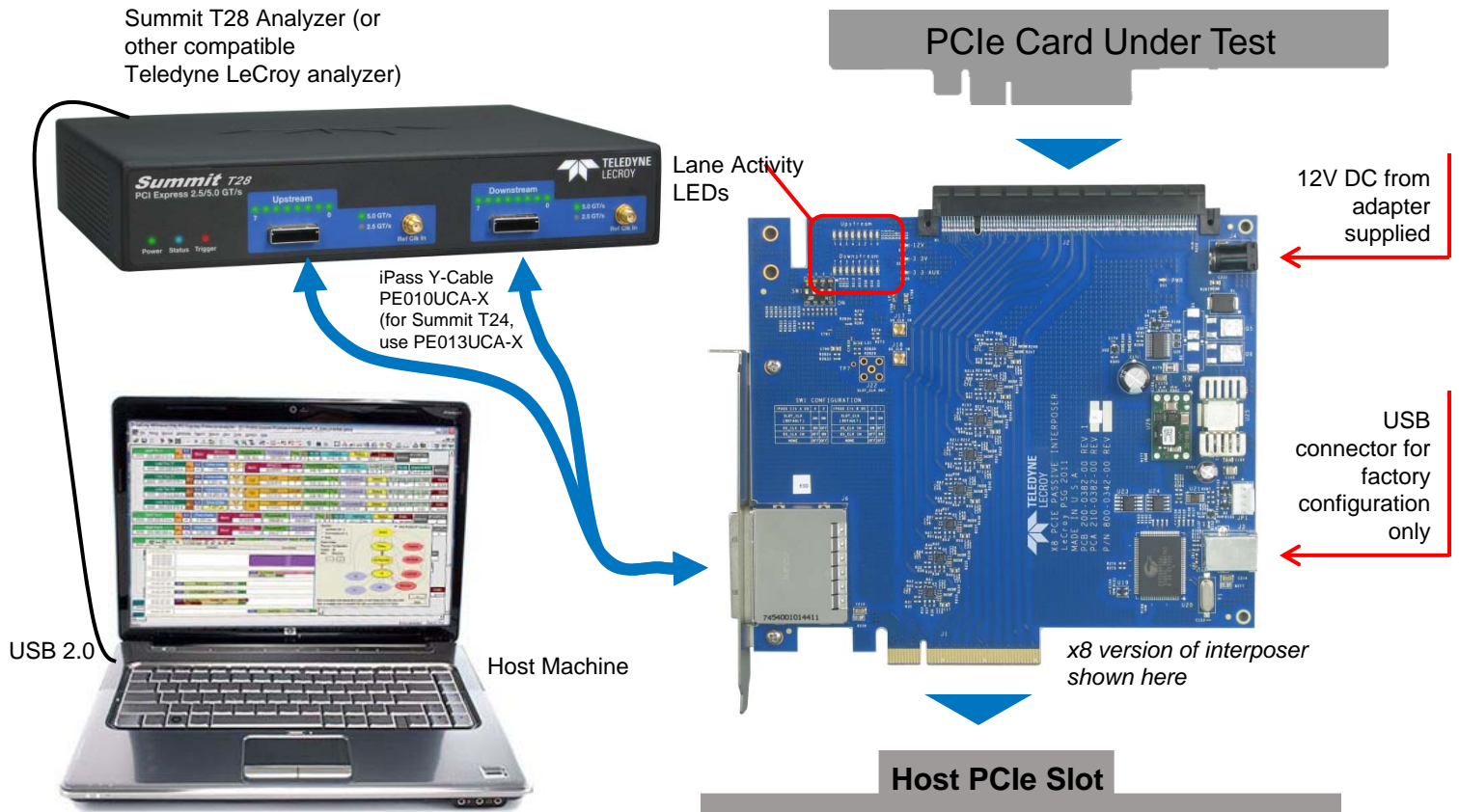

Connecting the Gen2 Passive Interposer

1. Install the Interposer into the host system PCIe connector, using a card edge reducer adapter if needed.
2. Install the PCIe expansion card under test (DUT) into the connector on the interposer. Note that PCIe expansion cards with edge connectors up to x16 can fit the connector on all versions of the passive interposer, but the maximum lane width that can be negotiated for traffic flowing through the interposer is the specified lane width of the interposer.
3. Connect 12V DC using the AC adapter supplied with the interposer. Make sure that the AC adapter is turned on.
4. Connect the Summit T28 Analyzer (or other compatible Teledyne LeCroy analyzer) to the interposer using an iPass Y-cable. (x16 version requires two Y-cables to connect to Summit T3-16. If using a Summit T24 or T34, use a PE013UCA-X iPass x4-to-x8 Straight Cable.)
5. Connect the analyzer to a host machine using the USB 2.0 port on the back panel of the Summit T28 analyzer.
6. Install the software on the host machine.
7. Power on the analyzer.
8. Power on the host system.
9. Use the Teledyne LeCroy software application to monitor, record and view PCI Express traffic in the PCI expansion card DUT system.

Clock Configuration DIP Switches

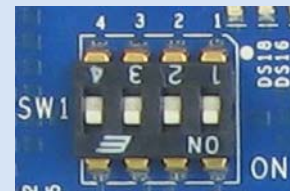

| iPass Clk A US | 4 | 3 | iPass Clk B DS | 2 | 1 |
|--------------------|-----|-----|--------------------|-----|-----|
| SLOT_CLK (Default) | ON | ON | SLOT_CLK (Default) | ON | ON |
| US_CLK IN | ON | OFF | US_CLK IN | ON | OFF |
| DS_CLK IN | OFF | ON | DS_CLK IN | OFF | ON |
| NONE | OFF | OFF | NONE | OFF | OFF |

| System Compatibility | |
|----------------------|------|
| Summit T3-16 | ✓ |
| Summit T3-8 | ✓(1) |
| Summit T34 | ✓(2) |
| Summit T28 | ✓(3) |
| Summit T24 | ✓(2) |

- (1) Compatible with x16 if using two T3-8 systems. In this configuration, connect the analyzers to each other with the Summit T28 Expansion Cable.
- (2) Compatible with x8 if using two T24 or T34 systems. In this configuration, use an iPass Y-Cable to connect the analyzers to the interposer and connect the analyzers to each other with the appropriate expansion cable.
- (3) Compatible with x8, x4 and x1 versions only.



1-800-909-7211
teledynelecroy.com

Local sales offices are located throughout the world.
Visit our website to find the most convenient location.